

Step-by-step instructions on configuring your amplifier.

The Axiom Warranty

All our speaker models; towers, bookshelves, surrounds, centers, subwoofers and all our amplifiers; subwoofer and multichannel amplifiers are warrantied against manufacturer's defects for 5 years.

AXIOM CANADA INC. warrants this audio loudspeaker system (the "Product") to be free from original manufacturing defects in materials and workmanship for five years from date of purchase from an authorized Axiom dealer. This warranty extends only to the original consumer purchaser. AXIOM CANADA INC. does not warrant goods used in commercial or industrial applications. This warranty does not cover any expenses incurred in any removal or re-installation of the product.

If the product should prove so defective within the warranty period, return the product by prepaid delivery to AXIOM CANADA INC., along with the original sales invoice or other proof of purchase, which establishes eligibility for warranty service. AXIOM CANADA INC. will, at its option, replace or repair the product free of charge and return the product by prepaid delivery. This warranty does not apply to any product, which has been damaged, misused, altered or repaired by anyone other than an AXIOM CANADA INC. authorized service facility.

Any implied warranties including fitness for use and merchantability are limited in duration to the period of the express warranties set forth above, and no person is authorized to assume for Axiom Canada Inc. any other liability in connection with the sale of the product. Axiom Canada Inc. expressly disclaims liability for any incidental and consequential damages caused by the product. The remedies provided under this warranty are exclusive and in lieu of all others.

This warranty gives specific legal rights. In addition, there may be other legal rights arising from the sale of the product, which vary from province to province or state to state. Some provinces / states do not allow the exclusion or limitation of incidental or consequential damages, so the above limitation or exclusion may not apply in some areas.



Important Safety Instructions

1. Read these instructions.
2. Keep these instructions.
3. Heed all warnings.
4. Follow all instructions.
5. Do not use this apparatus near water.
6. Clean only with dry cloth.
7. Do not block any ventilation openings. Install in accordance with the manufacturer's instructions.
8. Do not install near any heat sources such as radiators, heat registers, stoves, or other apparatus (including amplifiers) that produce heat.
9. Do not defeat the safety purpose of the polarized or grounding-type plug. A polarized plug has two blades with one wider than the other. A grounding type plug has two blades and a third grounding prong. The wide blade or the third prong are provided for your safety. If the provided plug does not fit into your outlet, consult an electrician for replacement of the obsolete outlet.
10. Protect the power cord from being walked on or pinched particularly at plugs, convenience receptacles, and the point where they exit from the apparatus.
11. Only use attachments/accessories specified by the manufacturer.
12. Use only with the cart, stand, tripod, bracket, or table specified by the manufacturer, or sold with the apparatus. When a cart is used, use caution when moving the cart/apparatus combination to avoid injury from tip-over.
13. Unplug this apparatus during lightning storms or when unused for long periods of time.
14. Refer all servicing to qualified service personnel. Servicing is required when the apparatus has been damaged in any way, such as power-supply cord or plug is damaged, liquid has been spilled or objects have fallen into the apparatus, the apparatus has been exposed to rain or moisture, does not operate normally, or has been dropped.
15. Do not expose this apparatus to dripping or splashing and ensure that no objects filled with liquids, such as vases, are placed on the apparatus.
16. To completely disconnect this apparatus from the AC Mains, disconnect the power supply cord plug from the AC receptacle.
17. The main plug of the power supply cord shall remain readily operable.
18. Do not expose batteries to excessive heat such as sunshine, fire or the like.



The lightning flash with arrowhead symbol within an equilateral triangle, is intended to alert the user to the presence of uninsulated "dangerous voltage" within the product's enclosure that may be of sufficient magnitude to constitute a risk of electric shock to persons.



The exclamation point within an equilateral triangle is intended to alert the user to the presence of important operating and maintenance (servicing) instructions in the literature accompanying the product.

WARNING : To reduce the risk of fire or electric shock , do not expose this apparatus to rain or moisture.

SAFETY PROCEDURES

- Ensure that you connect your Amplifier only to the type of power supply indicated on the amplifier faceplate, and ensure that the power cord cannot be walked on or otherwise damaged.
- To prevent electric shock, match wide blade of plug to wide slot, fully insert.
- Ensure that objects or liquids are not allowed to penetrate the enclosure.
- Your AXIOM Subwoofers are finished in a Die Cast Aluminum and from time to time should be wiped clean gently with a slightly damp cloth to remove any dust or stains.

For any additional information or service, contact:

AXIOM, 2885 HWY 60
DWIGHT ON CANADA
P01 1H0

Phone: 1-866-244-8796

Step 1:

Set the voltage switch on the bottom of the A1400-2 to the appropriate voltage for your country. The voltage switch is preset at the factory for 115 volts (North America and Japan). For most of the rest of the world the voltage switch will need to be changed to 230 volts. Damage will occur if you plug into a 230 volt line with the switch in the 115 position.

Step 2:

WARNING: DO NOT use the A1400-2 amplifier with any type of constant-impedance speaker switcher or with any whole-house multiple speaker installation that uses such devices. Damage to the A1400-2 and or the speaker switcher may result.

Insert the supplied power cord into your A1400-2 and place the amp on its feet. Do not plug the amplifier into the wall outlet until all hook-up steps are completed.

Step 3:

Main switch should remain in the off position "O" until all hook-up steps are complete.

Step 4:

Connect each of your speaker channels to a channel of the A1400-2. Be sure to put the wire from the speaker + (positive) to the terminal marked + (positive) on your A1400-2 and the wire from the speaker - (negative) to the terminal marked - (negative) on your A1400-2. It is wise to label each speaker wire as to where in your system it goes; i.e. LF and RF. **WARNING: Check that none of your speaker wires (or wire strands) touch or are short-circuited to other speaker connections or to the amplifier's metal chassis. SERIOUS DAMAGE WILL OCCUR IF MORE THAN 200 WATTS IS SHORT-CIRCUITED TO CHASSIS GROUND OR ANOTHER SPEAKER TERMINAL.**

Step 5:

Connect each channel from your pre-amp to the appropriate input i.e. the Left Front input cable will plug in directly above the LF speaker cable you hooked up in step 4. Your A1400-2 allows for three types of input connector from your pre-amp; XLR, 1/4 Phone, and RCA by using the supplied adaptors. The 1/4 phone plugs into the center of the XLR input. Your A1400-2 comes with 2 straight and 2 ninety degree 1/4" Phone to RCA adaptors allowing you options for wire management. **SERIOUS DAMAGE WILL OCCUR IF EITHER THE HOT OR GROUND OF THE INPUT CABLE IS SHORTED TO THE POSITIVE LEAD OF ANY SPEAKER OUTPUT. DO NOT USE XLR TO RCA ADAPTORS, ONLY USE THE 1/4 PHONE TO RCA ADAPTORS LIKE THE ONES SUPPLIED.**

A1400-2 Digital Amplifier

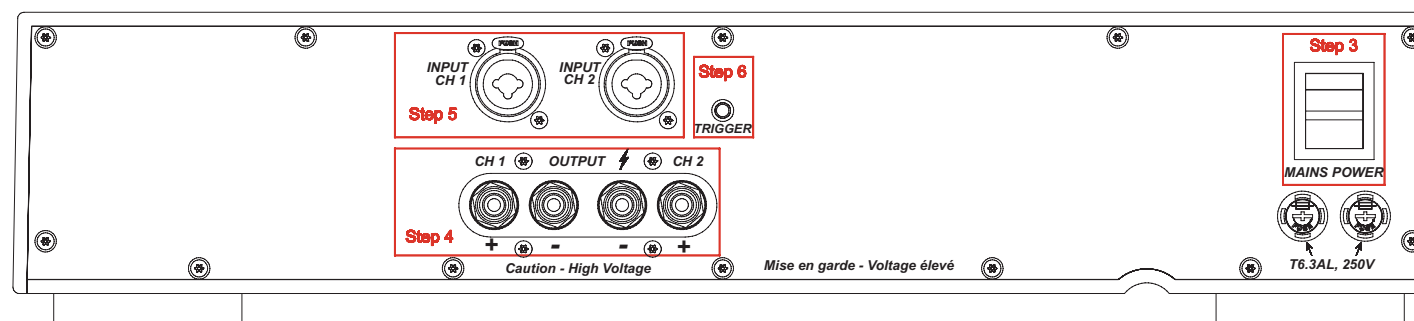
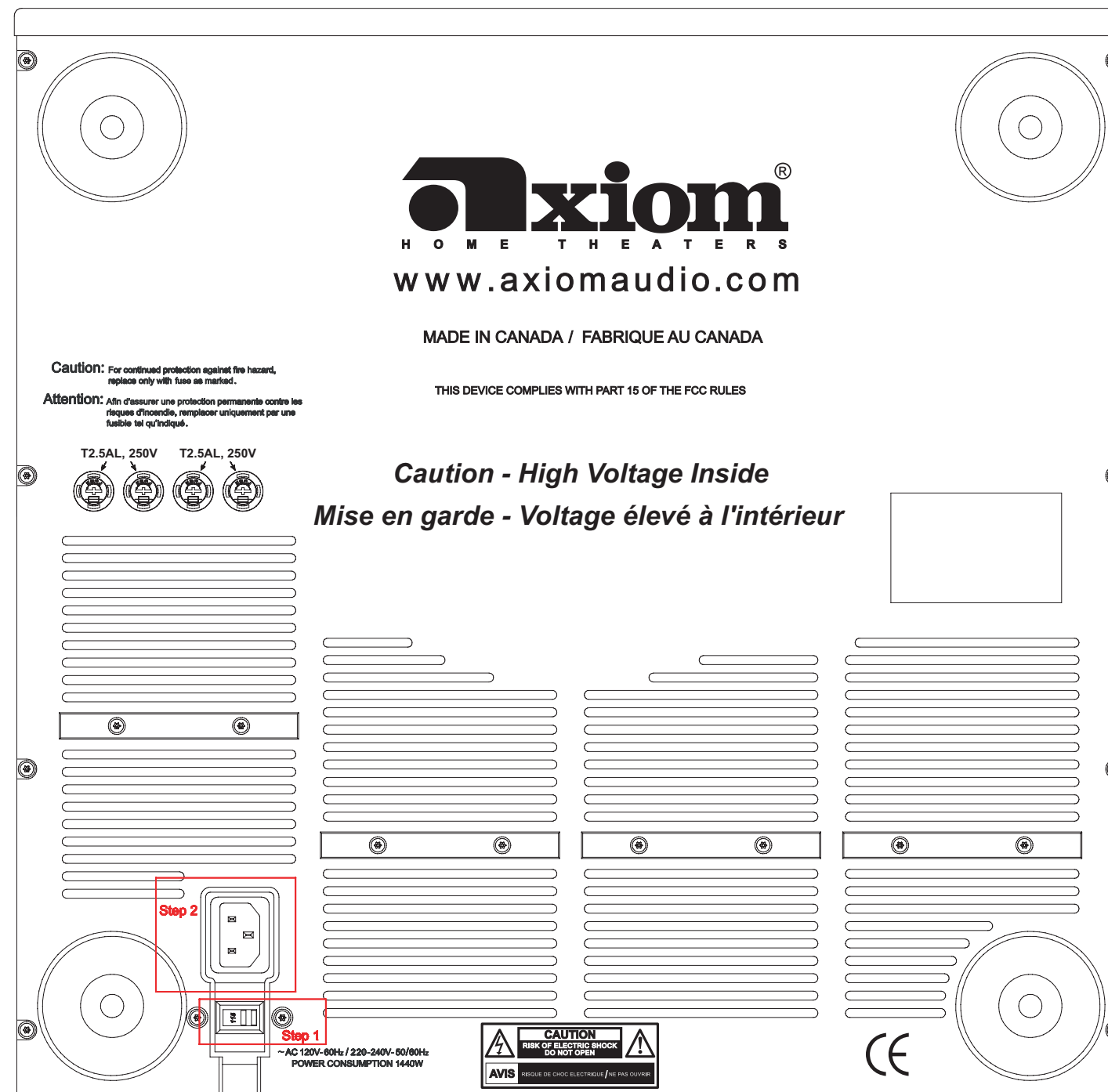

Step 6:

The trigger input is an optional hook-up. If your processor has a 12-volt trigger output, you can run a 3.5mm connector cable to the amplifier trigger input and your A1400-2 will power on and off with your processor. **NOTE: The front button (Step 8) must be in the OFF position for the trigger to operate.**

Step 7:

Plug your power cord into the wall and turn on the mains power switch (see Step Three).

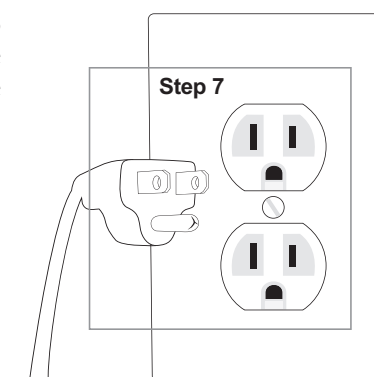

Step 8:

Push to power on your A1400-2. The ring around the on/off button will glow blue when ON.

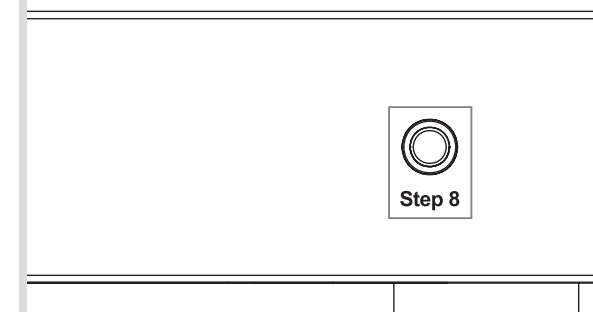

Precautions:

Air flow in the bottom vents and out the top vents of your A1400-2 is very important. Do not block these vents in any way. Your A1400-2 is designed to operate in ambient temperatures up to 30 degrees C (86 F). Since the A1400-2 will actually cool down as you increase the output please be sure to turn off your amplifier in very high ambient temperature conditions when not in use.

NEED HELP TROUBLESHOOTING?

Please feel free to contact us at 1-866-244-8796 or www.axiomaudio.com